

VA 525 – 固定式高性能流量計

- 可同時量測流量、溫度、壓力，結合三數據為一體
- 管內內建風向整流器，自動將風向整理，測量出更精準地數值

新開發的 VA 525 結合多種數位訊號輸出，可將數據連接到工廠監控系統，隨時監控廠內流量數據，VA525 精巧且堅固的設計及經濟實惠的價格，是許多工程公司及氣體流量監控廠商的第一首選。



顯示螢幕可以同時顯示2種數值並量測以下數據:

- 流量數據(m³/h, l/min,...)
- 累積流量數據(m³, l, kg)可歸零
- 溫度數據
- 壓力數據(OPTIONAL)

產品優勢:

- 流量計精巧且堅固的設計 – 使用上不受空間限制。
- 可選擇傳統類比輸出 (4...20 mA 及 pulse) 或是使用數位輸出 Modbus RTU, Ethernet (PoE), M-Bus · 將數據傳送到主控室進行監控。
- 所有數據調整(單位、累積流量歸零等等...)皆可在顯示窗上做更改。

安裝管線尺寸:

提供各種尺寸大小，輕鬆安裝在現有的管路上 (可選擇 1/4", 1/2 ", 3/4", 1 ", 1 1/4", 1 1/2 " or 2" 尺寸)

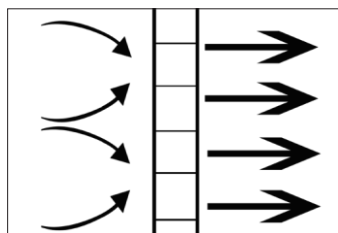

內建風向整流器 – 無需再額外安裝測量段

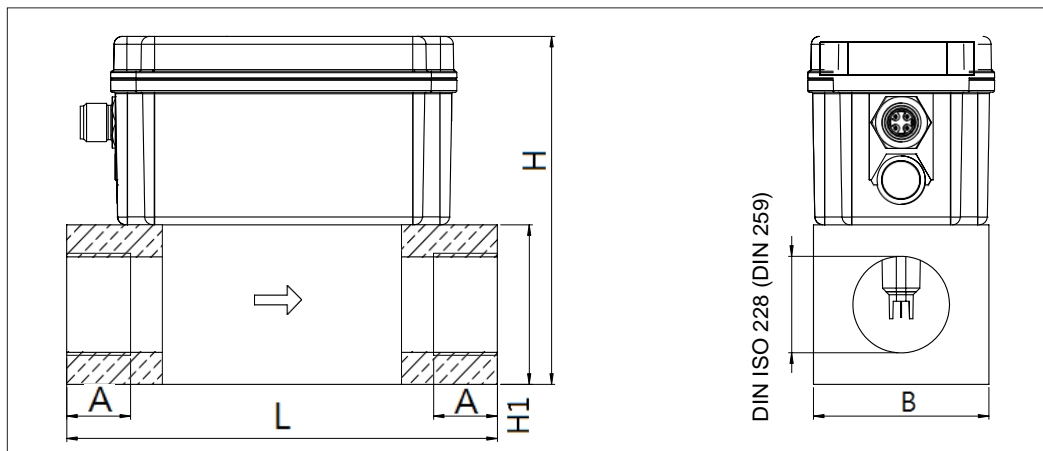

調整顯示窗功能:

- 利用按鍵可將累積流量歸零
- 利用按鍵更改所需單位
- 參數化界面

Measuring ranges flow VA 525 (Max version 185 m/s) for compressed air (ISO 1217: 1000 mbar, 20 °C). Measuring ranges for other types of gas see pages 94 to 97

Measuring section	Thread	Measuring range		L mm	B mm	H1 mm	H mm	A mm
		m ³ /h	cfm					
DN 8	G 1/4"	105 l/min	3,6	135	55	50	109,1	15
DN 15	G 1/2"	90 m ³ /h	50	135	55	50	109,1	20
DN 20	G 3/4"	170 m ³ /h	100	135	55	50	109,1	20
DN 25	G 1"	290 m ³ /h	170	135	55	50	109,1	25
DN 32	G 1 1/4"	530 m ³ /h	310	135	80	80	139,1	25
DN 40	G 1 1/2"	730 m ³ /h	430	135	80	80	139,1	25
DN 50	G 2"	1195 m ³ /h	700	135	80	80	139,1	30

VA 525 order code:

0695 5250_A1_B1_C1_D1_E1_F1_G1_H1_I1_J1_K1_L1_M1_R1

管徑尺寸:	
A1	1/4"
A2	1/2"
A3	3/4"
A4	1"
A5	1 1/4"
A6	1 1/2"
A7	2"

螺紋種類:	
B1	G female thread
B2	NPT female thread

材質:	
C1	Aluminium

校正報告:	
D1	No real gas adjustment - gas type setting by gas constant
D2	Real gas calibration in the gas type selected below

氣體種類:	
E1	Compressed air
E2	Nitrogen (N2)
E3	Argon (Ar)
E4	Carbon dioxide (CO2)
E5	Oxygen (O2)
E6	Nitrous oxide (N2O)
E90	Additional gas / please specify gas type (on request)
E91	Gas mixture (see page 72 - G91)

測量範圍 (請參考上頁表格)	
F1	Low Speed version (50 m/s)
F2	Standard version (92,7 m/s)
F3	Max version (185 m/s)
F4	High Speed version (224 m/s)

參考標準	
G1	20 °C, 1000 mbar
G2	0 °C, 1013,25 mbar
G3	15 °C, 981 mbar
G4	15 °C, 1013,25 mbar

顯示窗	
H1	with integrated display
H2	without display

是否增添壓力數據	
I1	without pressure sensor
I2	with integrated pressure sensor 0 ... 16 bar (output only via digital interfaces)

數位輸出訊號	
J1	1x 4...20 mA analog output for actual flow and pulse output
J2	Modbus-RTU (RS485)
J3	Ethernet-Interface (Modbus/TCP)
J4	Ethernet-Interface Power over Ethernet (Modbus/TCP)
J5	M-Bus

整流器	
K1	with integrated flow straightener, no additional inlet pipe necessary (with measuring block 1/2" to 2")
K2	without flow straightener (with measuring block 1/4")

精準度	
L1	± 1,5% of m. v. ± 0,3% of f. s.
L2	± 6% of m. v. ± 0,5% of f. s.
L3	± 1% of m. v. ± 0,3% of f. s.

壓力範圍	
M1	16 bar

特殊規格	
N1	Standard design
N2	Special cleaning oil and grease-free (e. g., for oxygen use, etc.)

特殊測量範圍	
R1	Special measuring range (please specify when ordering)

DESCRIPTION	ORDER-NR.
Compact inline flow sensor	0695 5250 + order code A...R_

VA 525 產品規格

參考數據:	m ³ /h, l/min (1000 mbar, 20 °C) in case of compressed air resp. Nm ³ /h, NI/min (1013 mbar, 0°C) in case of gases
可選擇的單位:	m ³ /h, m ³ /min, l/min, l/s, ft ³ /min, cfm, m/s, kg/h, kg/min, g/s, lb/min, lb/h
傳感器類型:	Thermal mass flow sensor
量測介質:	Air, gases
可選擇氣體種類 (需透過CS Service 軟體 或CS 記錄器 調整)	Air, nitrogen, argon, CO2, oxygen
量測範圍:	See table above
精準度:	± 1,5 % of m. v. ± 0,3 % of f. s. By request: ± 1 % of m. v. ± 0,3 % of f. s. or ± 6 % of m. v. ± 0,5 % of f. s.
壓力量測 (OPTIONAL):	0...16 bar, accuracy: 1%
溫度範圍:	-30...80 °C
壓力範圍:	Up to 16 bar
數位輸出:	RS 485 interface (Modbus RTU), M-Bus (optional) Ethernet interface or PoE
類比輸出(流量):	4...20 mA for m ³ /h resp. l/min
脈衝輸出(累積流量):	1 pulse per m ³ or per liter galvanically isolated. Pulse value adjustable on the display. Alternatively, the pulse output can be used as an alarm relay.
電源供應:	18...36 VDC, 5 W
Burden:	< 500 Ω
外殼材質:	Polycarbonate (IP 65)
量測級材質:	Aluminium
螺紋尺寸:	G 1/4" to G 2" (BSP British standard piping) resp. 1/2" to 2" NPT-thread